

APPENDIX C

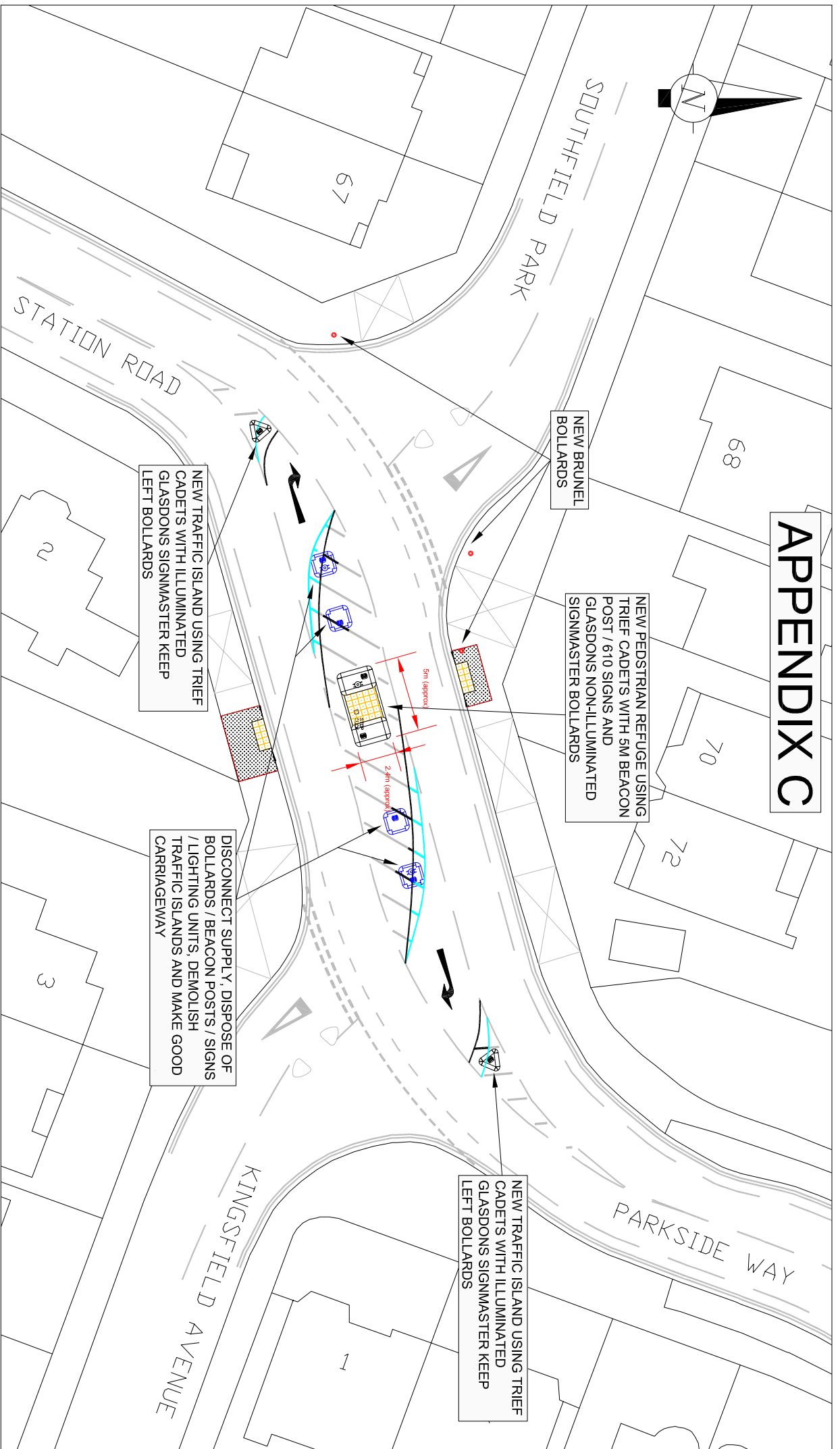

NOTES:

This map is reproduced from or based upon Ordnance Survey material with the permission of Ordnance Survey on behalf of the Controller of Her Majesty's Stationery Office. It is reproduced by permission of the Controller of Her Majesty's Stationery Office. Ordnance Survey is a registered trademark of Ordnance Survey. Ordnance Survey, the Ordnance Survey logo and the words Ordnance Survey are registered trademarks of Ordnance Survey. Ordnance Survey, the Ordnance Survey logo and the words Ordnance Survey are registered trademarks of Ordnance Survey. Ordnance Survey, the Ordnance Survey logo and the words Ordnance Survey are registered trademarks of Ordnance Survey.



ENVIRONMENT & ENTERPRISE
TRANSPORTATION

P.O. Box 39, Civic Centre,
Harrow, Middlesex, HA1 2XA
Tel: 020 8863 5611
Fax: 020 8420 9611

Designation Details of Revision

---	---
-----	-----

Date Sign

-/-/-	--
-------	----

Project

**PARKSIDE WAY
PROPOSED PEDESTRIAN
IMPROVEMENTS**

Scale	Drawn	Checked
NTS	JA	---
© A3	Date	
	12/11/14	
Drawing no		
T/DWG/000752		
Autocad file		
C:\Traffic\Projects\TP163\Parkside Way\		
3_Design\		